



## Using Calor Gas Safely - Butane

### Butane Cylinders 7kg & 15 kg Sizes

#### 1. Do when using Calor Butane

- **Do** treat a cylinder with care to ensure that the valve is not damaged.
- **Do** always use cylinders in the upright position unless specifically designed for liquid offtake.
- **Do** return cylinders when empty or when not in use for long periods.
- **Do** read the instructions and labels provided with your appliance and keep them handy for future reference.
- **Do** keep your appliance clean and have it serviced regularly by a competent person. Not only will this help to keep it safe but also means it will burn efficiently and therefore save money.
- **Do** ensure there is an adequate supply of fresh air in the room where your appliance is used. If a room has ventilators or grilles, ensure these are open. If a room becomes stuffy, open a window or door immediately.
- **Do** try to exchange full for empty cylinders out of doors. A change indoors should only be done away from any sources of ignition such as, open fires, boilers, electric heaters, pilot lights, lit cigarettes etc. The appliance must also be switched off and preferably allowed to cool before the cylinder change takes place.
- **Do** be careful when lifting cylinders. Full cylinders weigh approximately twice the net weight shown on the cylinder.
- If you have any queries, please contact the retailer or outlet who sold you the cylinder.

#### 2. Don't when using Calor Butane

- **Don't** subject a cylinder to heat as the pressure inside could build up to exceed the safe limit
- **Don't** attempt to unscrew or disconnect a clip-on or screw-on regulator or valve wheel from any cylinder if the flame does not go out when the regulator is turned off. Leave appliance alight and call your local Calor Gas retailer or call the **Calor Gas Emergency Service** number **03457 444 999**.
- **Don't** store or use cylinders in cellars or below ground level. LPG is heavier than air and if there was an escape the gas will collect at low level, can be an asphyxiant, and could become dangerous in the presence of a flame or spark. For the same reason do not store cylinders any closer than 2 metres from un-trapped drains, unsealed gullies or openings to cellars.
- **Don't** attempt to force a regulator of one size on to a cylinder's valve of another size. If you have any difficulties contact your Calor Gas Retailer and have the appliance checked.
- **Don't** improvise or modify your gas appliance. Always ask your Calor Gas retailer for advice and do not let unqualified people tamper with or service your appliance. It could become unsafe to use.
- **Don't** obstruct access to cylinders.



## Using Calor Gas Safely - Butane

### 3. Carbon Monoxide

Carbon monoxide (CO) is a highly poisonous gas which can be produced if an appliance is not working correctly. It is difficult to recognise as it has no colour, smell or taste. Symptoms of CO poisoning are similar to that of a viral infection. It affects the mental ability causing a person to become incapable without knowing. Carbon Monoxide detectors (complying with BS:EN:50291) are widely available and it is recommended that every property has one. CO detectors have a lifetime of 5 to 10 years and should be tested regularly.

#### Symptoms of exposure to Carbon Monoxide

- Tightness across the forehead & headache
- Severe headache, weakness, dizziness, nausea, vomiting.
- Coma, intermittent convulsions
- Depressed heart action slowed respiration.

If the exposure has been severe, it may cause death.

If you suspect you are suffering from the symptoms above **call 111** to seek medical advice and call the Calor Gas Emergency Service number on **03457 444 999**.

### 4. The Regulator

A regulator must be included in the connection between the cylinder and the appliance, except for appliances designed to be supplied at cylinder pressure. The regulator is precisely set by the manufacturer to control the pressure of the supply and **Must Not Be Adjusted**. If a Regulator shows signs of wear, it should be replaced. **New Regulators should be clearly marked to BS: EN:16129. This Standard has superseded regulators previously marked to BS:3016 or BS:EN:12864. Regulators marked with BS:3016 are over 10 years old and should be replaced as should other regulators with over 10 years' service life.**

### 5. Flexible Hoses

Use only certified hoses to **BS:EN:16436-1 Class 2** (medium pressure up to 10bar) which **bear the year and name of manufacturer** as LPG attacks and erodes natural rubber. Keep hose lengths as short as possible. **All hoses must be secured with proper hose clips (see Liquid Gas UK Consumer Guidance Sheet No.17).** Butane pigtails (mainly for caravans etc.) should use to **BS:EN:16436-1 Class 3** hose with an appropriate cylinder adaptor. Make sure that the hoses are kept clear of 'hot spots' and inspect them from time to time. **BS:EN:16436-1 Classes 2 & 3 hose has superseded those marked to BS:3212 Type 2.** Replace any hose that shows signs of wear, cracking or damage. **Hoses fitted to cabinet heaters must be marked BS: EN:16436-1 Class 2** (medium pressure up to 10bar) **and be of 8mm inside diameter.**



## Using Calor Gas Safely - Butane

### 6. Emergency Advice

If you suspect a leak, turn off the gas, open all the doors and windows and ensure there is no source of ignition nearby e.g., do not operate electrical switches, extinguish any cigarettes and switch off your mobile phone. Examine all pipes and connections. If the leak is not located, turn on the gas supply and brush over the connections with leak detection fluid to **BS:EN:14291** – it will bubble where there is a leak. Do not use washing up liquid due to its high chloride levels.

**NEVER USE A NAKED FLAME** to search for a leak. A suitably calibrated Explosimeter may be used for testing the concentration of LPG in the air, but Calor Butane has a special odorant added to help with the detection of leaks.

#### In the Event of Fire

- Immediately raise the alarm, **Dial 999** and call the **Fire Brigade** advising them of the presence of LPG.
- Shut all valves on cylinders.
- Keep cylinders cool by water spray, if possible.

Ring the **Calor Gas Emergency Service number 03457 444 999**

### 7. Further Information

For further information, advice and guidance please refer to the following publications: -

- Liquid Gas UK Consumer Guidance Sheet No 28: 'Safe Use of Propane and Butane Cylinders and Cartridges'
- Liquid Gas UK Code of Practice 24: Part 1 - Use of LPG Cylinders: Use of LPG Cylinders at Residential and Similar Premises (July 2006)
- Liquid Gas UK Consumer Guidance Sheet No.17: 'Use of Clips to Secure Vapour Phase LPG Hose and Tubing to BS EN 16436-1 (Classes 1, 2 and 3) to End Fitting'

Liquid Gas UK produce over 30 Industry Codes of Practice and Guidance. For a comprehensive publication list please go to the Liquid Gas UK website: <https://www.liquidgasuk.org>



## Using Calor Gas Safely - Butane

### 8. Connecting 7Kg and 15Kg Butane cylinders

**There are various 21mm regulators available. Please refer to your manufacturer's instructions for guidance on how to connect and disconnect the regulator.**

7kg and 15kg Butane Cylinders have a 21mm valve and must only be used with a 21mm regulator.

1. Turn the orange cap so that the arrow is pointing to the gap in the shroud.
2. Remove the orange safety cap by pulling the lanyard out, then up and leave the cap hanging.  
**Do not use tools to remove.**
3. Check the black sealing washer is fitted inside the cylinder valve.
4. Ensure the regulator switch is in the disconnect 'off' position.
5. Fit the 21mm regulator to the cylinder valve, as per the manufacturer's instructions.
6. When gas is required, turn the switch to the 'on' position as defined in the manufacturer's instructions.

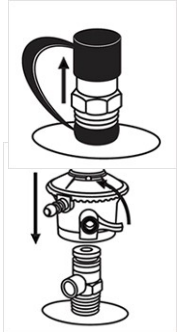

If the regulator on/off switch gets stuck when turning the supply on, it means that the regulator has been connected incorrectly. In this event the regulator must be disconnected and the correct steps to reconnect repeated from the beginning.

### 9. Disconnecting 7Kg and 15Kg Butane cylinders

**There are various 21mm regulators available. Please refer to your manufacturer's instructions for guidance on how to connect and disconnect the regulator.**

1. Never disconnect the Regulator with the switch in the 'on' position.
2. Turn the regulator switch to the 'off' position.
3. Wait until the burner and pilot lights have gone out. If the flame does not go out, turn the switch back to on; leave the appliance alight and contact the **Calor Gas Emergency Service number on 03457 444 999.**
4. To remove the regulator from the cylinder valve please refer to the manufacturer's instructions.
5. Replace the orange safety cap onto the cylinder valve of the empty or part full cylinder, when not in use.

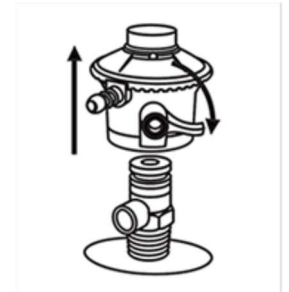

The information in this document is intended to give guidance and believed to be accurate and represent good practice at the time of publication. It does not replace the need to consult other formal documents where further information may be required.

No responsibility or liability is accepted by Calor Gas Limited for any loss or damage arising out of the information given. It is important that users of this publication adhere to all legal requirements, Regulations, CoP's and Standards, particularly, those relating to gas safety.

All rights reserved. No part of this publication may be reproduced, stored in a retrieval system or transmitted in any form, or by any means, electronic, electrostatic, magnetic tape, mechanical, photocopying, recording, or otherwise, without permission in writing from Calor Gas Ltd.